

Rosy

LED Walkover
Inground Luminaire

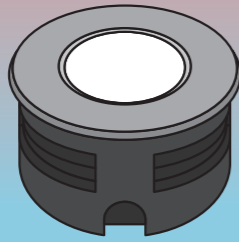

Ideal for:
Footpaths and gardens

Subtle and harmonious Rosy illuminates the way,
making the perfect guide.



IP66/67



IK09



C4

- Strongly diffused uniform light surface to reduce perceived glare
- High corrosion resistance (C4) and water ingress protection
- Supplied with a heavy duty rubber connection cable with integrated waterstop
- Compatible with THORNeco cable system

- Adaptor with open leads included
- Natural colour temperature provides comfort for pathway users
- Low overall height decreases required space and depth for installation
- Suitable for installation in concrete/soil/wood
- Compatible with all the PLUG&PLAY outdoor sensor accessories (sensor, daylight, photocell)

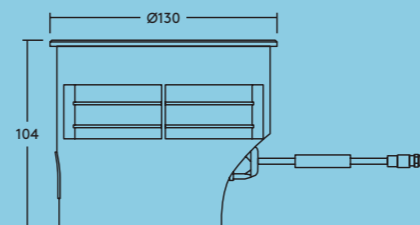

Specification

Electrical class	I
Ambient operating temperature	-20 to +50 °C

Installation / Mounting

Mounting	Suitable for installation in concrete/soil/wood Pre-wired with mains cable and adapter with open leads (1.5mm ²) H07RN-F connection cable Salt resistant according to corrosion class C4
----------	---

Material / Finish

Body	Stainless steel AISI 316, aluminium die-cast
Screws	Hex socket, stainless steel AISI 316 with GEOMET® 500 coating
Front cover	Tempered frosted glass
Sleeve	PC

Light source information

Colour temperature	3000 K
Lumen	350lm (6W)
Efficiency	up to 58lm/W
Lifetime	50 000 hours (@L80, Ta 25 °C)

Ordering guide

Description	Cat Number
ROSY INGROUND IP67 350 830	ROS350Z3K
Accessories	
ECO PIR SENSOR	ECOPIR
ECO PC SENSOR	ECOPCELL

Compatible THORNeco cable system

